

# MUFFLERS Made of Plastic

M3 × 0.5 ~ R1/2

- Offer superior noise suppressing effect.
- Low resistance to air flow, thus avoiding adverse effects on equipment operations.
- Compact and lightweight, for easy mounting.
- Offer a long operating life. Elements do not corrode over time, and maintain superior moisture and oil resistance.
- Cleaning with petroleum, etc., is a simple operation.

## Symbol



## Specifications

Item		Model	KM-03	KM-05	KM-10	KM-11	KM-22	KM-23	KM-31	KM-41
Port size			M3 × 0.5	M5 × 0.8	R1/8		R1/4		R3/8	R1/2
Media			Air							
Operating pressure range		MPa [psi.]	0 ~ 0.7 [0 ~ 102]			0 ~ 0.9 [0 ~ 131]				
Proof pressure		MPa [psi.]	0.9 [131]			1.1 [160]				
Operating temperature range		°C [°F]	5 ~ 60 [41 ~ 140]							
Materials	Body		Polyacetal (Duracon)							
	Element		Expanded polyethylene (filtration rating 10 μm)	Polyvinyl alcohol resin (sponge, filtration rating 5 μm)	Sintered polyethylene (filtration rating 20 μm)		Sintered polyethylene (filtration rating 40 μm)		Sintered polyethylene (filtration rating 20 μm)	
Effective area	mm <sup>2</sup> [Cv]		1.0 [0.06]	4.0 [0.22]	5.5 [0.31]	15 [0.83]	21 [1.17]	43 [2.39]	65 [3.61]	74 [4.11]
Noise suppressing effect	dB		15 <sup>Note</sup>	13 <sup>Note</sup>	7	18	18	18	27	34
Mass	g [oz.]		0.5 [0.018]	1.0 [0.035]	0.9 [0.032]	4 [0.14]	4.5 [0.16]	18 [0.63]	19.5 [0.69]	22 [0.78]
Sales unit			One pack (10 pcs.)							

Note: Values at air pressure of 0.5MPa [73psi.] with installation in solenoid valve. (Solenoid valve used: **KM-03** for **040-4E1**, **KM-05** for **050-4E1**)

Item		Model	KM-J6	KM-J8	KM-J10	KM-J12
Port size			φ 6	φ 8	φ 10	φ 12
Media			Air			
Operating pressure range		MPa [psi.]	0 ~ 0.7 [0 ~ 102]			
Proof pressure		MPa [psi.]	0.9 [131]			
Operating temperature range		°C [°F]	5 ~ 60 [41 ~ 140]			
Materials	Body		Polyacetal (Duracon)			
	Element		Polyvinyl alcohol			
Effective area	mm <sup>2</sup> [Cv]		9.8 [0.54]	21 [1.17]	25 [1.39]	42 [2.33]
Noise suppressing effect	dB		23	33	35	28
Mass	g [oz.]		1.3 [0.046]	3.9 [0.138]	6.5 [0.23]	9 [0.32]
Sales unit			One pack (10 pcs.)			

## Dimensions (mm)

### ● KM-03

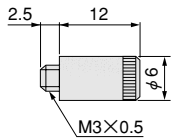

### ● KM-05

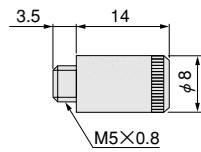

### ● KM-10

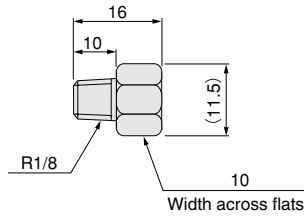

### ● KM-J6

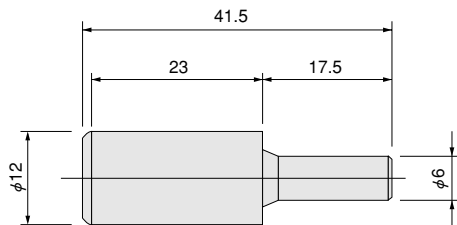

### ● KM-11 ~ KM-41

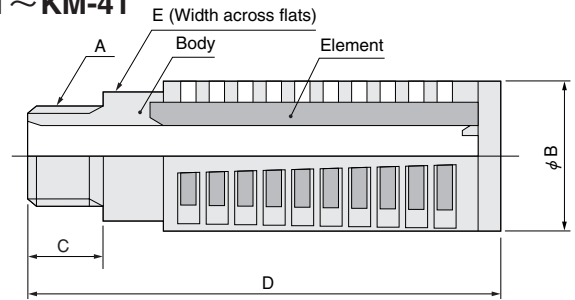

Code Model	A (R)	B	C	D	E (width across flats)
KM-11	1/8	16	7	33	14
KM-22	1/4	16	10	36	14
KM-23	1/4	20	10	62.5	17
KM-31	3/8	26	12	68	24
KM-41	1/2	28	15	71	24

### ● KM-J8 ~ KM-J12

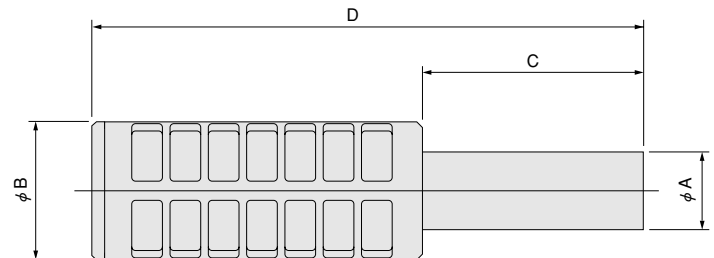

Code Model	A	B	C	D
KM-J8	8	15	26	64
KM-J10	10	18	30	73
KM-J12	12	20	35	83

## Handling Instructions and Precautions

- As the body is made of plastic, do not subject it to excessive force.
- For cleaning, use a neutral detergent or cleaning oil. Do not use thinner, benzene, or other solvents.

### ● KM-03, KM-05

Use fingertips to tighten for mounting. Use of pliers or other tools could damage the unit.

### ● KM-10 ~ KM-41

Use fingertips to tighten until it stops. Then, use a tool to lightly tighten a little further.

### ● KM-J6 ~ KM-J12

Use by inserting into the quick fitting. After mounting, check that the muffler cannot be pulled out.

# MUFFLERS Made of Brass

M5 × 0.8, R1/8 ~ R1

- Made of sintered brass, which assures superior mechanical strength.
- Compact body takes up little installation space.

## Symbol

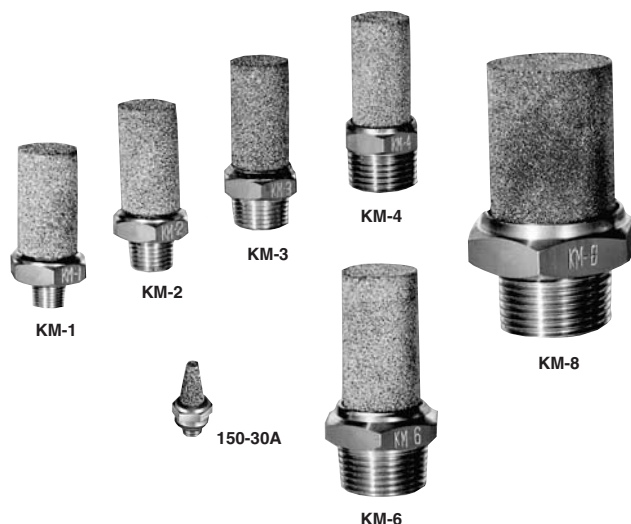

## Specifications

Item	Model	150-30A	KM-1	KM-2	KM-3	KM-4	KM-6	KM-8
Port size		#10-32 Unified thread (Can be used with M5×0.8)	R1/8	R1/4	R3/8	R1/2	R3/4	R1
Media		Air						
Operating pressure range	MPa [psi.]	0~0.9 [0~131]						
Proof pressure	MPa [psi.]	1.3 [189]						
Operating temperature range	°C [°F]	5~60 [41~140]						
Materials	Body	Brass						
	Element	Sintered brass (Porous rating of air pass section: 60 μm)						
Effective area	mm <sup>2</sup> [Cv]	3.5 [0.194]	17 [0.94]	42 [2.33]	50 [2.78]	56 [3.11]	103 [5.72]	199 [11.1]
Noise suppressing effect	dB	14	1	6	13	8	15	12
Mass	g [oz.]	3 [0.11]	52 [1.83]	53 [1.87]	55 [1.94]	61 [2.15]	150 [5.29]	335 [11.82]
Sales unit		One pc.						

## Dimensions (mm)

### ● 150-30A

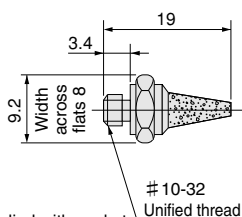

- Supplied with gasket

### ● KM-1 ~ KM-8

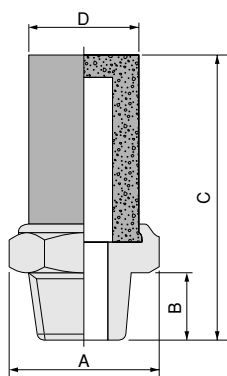

Code Model	Port size R	A (Width across flats)	B	C	D
KM-1	1/8	24 (21)	9	48	17.5
KM-2	1/4		10	49	
KM-3	3/8		12	51	
KM-4	1/2		15	65	
KM-6	3/4	36 (32)	20	80	23.5
KM-8	1	52 (46)	20	80	37

**Caution:** In normal conditions, use this muffler screwed into a valve exhaust port. Avoid using the muffler where heavy flow impact can occur, such as for passing of exhaust air from a quick exhaust valve.